



THE VICTORIAN SOCIETY
CAMPAIGNING FOR VICTORIAN AND EDWARDIAN ARCHITECTURE

Press Release 6 February 2014

**TIMETABLE FOR THE PUBLIC INQUIRY INTO THE PROPOSED
PARTIAL DEMOLITION OF SMITHFIELD GENERAL MARKET, THE
ANNEX, AND RED HOUSE**

"If you go to St Bartholomew's and then walk through Smithfield, it is like walking from one cathedral to another. You wouldn't pull down St Bartholomew's, nor should you pull down Smithfield."

Alan Bennett

"Smithfield General Market is a beautiful example of Victorian Architecture. We should be treasuring this part of our heritage. What the Paris developers did to Les Halles is remembered as an act of Vandalism. Do we really want to be remembered as the generation who did the same thing to London?"

Kristin Scott Thomas

The Public Inquiry opens at 10.00 am on Tuesday, 11 February 2014, and is scheduled to last for 12 days, until Friday, 28 February.

Taking place at the Basinghall Suite at Guildhall (see map below), the inquiry is open to members of the public, and we would be very appreciative of a show of support from the public galleries.

Further details of the inquiry, including all the witness evidence submissions, can be found [here](#)

Or via the [SAVE](#) and [Victorian Society](#) websites

Sign up for updates: <http://www.savebritainsheritage.org/smithfield>

Guildhall, City of London

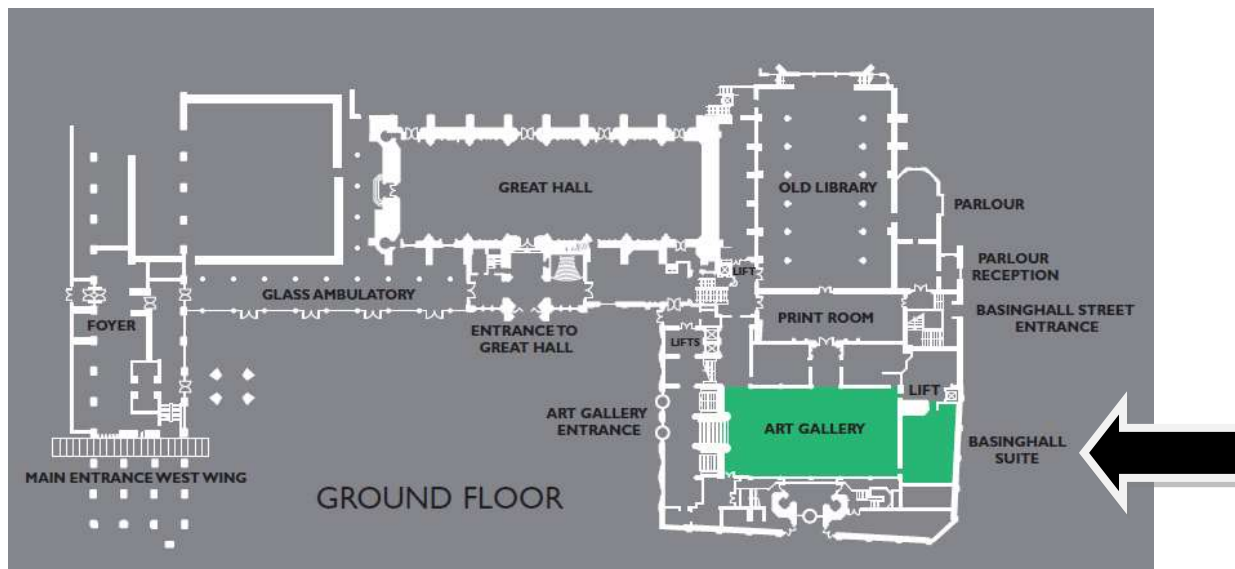

SMITHFIELD MARKET PUBLIC INQUIRY PROVISIONAL OUTLINE PROGRAMME (MAY BE SUBJECT TO CHANGE)

DAY 1 - 11TH FEB

- am Inspector's Opening remarks
- pm Henderson Global Investors – Architecture (John McAslan)

DAY 2 - 12TH FEB

- am Henderson Global Investors – Architecture (John McAslan)
- pm Henderson Global Investors – Townscape/Heritage (Peter Riddington)

DAY 3 – 13TH FEB

- am Henderson Global Investors – Viability (Andrew Tyler)
- pm Henderson Global Investors – Viability

DAY 4 – 14TH FEB

- am Henderson Global Investors – Planning (Alan Simmonds)
- pm City of London (Peter Wynne Rees)

DAY 5 - 18TH FEB

- am Greater London Authority (Stewart Murray)
- pm English Heritage (Nigel Barker)

DAY 6 – 19TH FEB

- am Any third party supporters
- pm SAVE and the Victorian Society – Architecture/significance (Dr Jenny Freeman)

DAY 7 – 20TH FEB

- am SAVE and the Victorian Society – Architecture/significance (Chris Costelloe)
- pm SAVE and the Victorian Society – sustainability/viability (Roger Hopher)

DAY 8 - 21ST - FEB

- am** SAVE and the Victorian Society – sustainability/viability (Roger Hepher)
SAVE and the Victorian Society – Town planning/urban design (Alec Forshaw)
pm SAVE and the Victorian Society – sustainability/viability (Eric Reynolds)

DAY 9 – 25TH FEB

- am** SAVE and the Victorian Society – sustainability/viability (Eric Reynolds)
pm SAVE and the Victorian Society – alternative scheme/marketing (Ian Lerner)

DAY 10 – 26TH FEB

- am** SAVE and the Victorian Society – Architecture and design (John Burrell)
pm Any third party objectors
s106 planning obligations/conditions

DAY 11 - 27TH FEB

- am** Accompanied site visit (not open to the public)
pm Accompanied site visit (not open to the public)

DAY 12 – 28TH FEB

- am** Closing submissions
pm Closing submissions

For more information and images, please contact:
The SAVE office on 0207 253 3500/office@savebritainsheritage.org
SAVE Director Clem Cecil on clem.cecil@savebritainsheritage.org
Victorian Society Director Chris Costelloe on
director@victoriansociety.org.uk/0208 994 1019



NOTES TO EDITORS:

SAVE Britain's Heritage has been campaigning for historic buildings since its formation in 1975 by a group of architects, journalists and planners. It is a strong, independent voice in conservation, free to respond rapidly to emergencies and to speak out loud for the historic built environment.

SAVE Britain's Heritage, 70 Cowcross Street, London EC1M 6EJ

Registered Charity 269129

Tel. 020 7253 3500 www.savebritainsheritage.org

Follow SAVE on Twitter: @SAVEBrit

The Victorian Society is the national charity campaigning for the Victorian and Edwardian historic environment.

It fights to preserve important Victorian and Edwardian buildings and landscapes so that they can be enjoyed by this and future generations. It provides expert advice to churches and local planning authorities on how Victorian and Edwardian buildings and landscapes can be adapted to the way we live now, while keeping what is special about them. It also advises members of the public about how they can help shape the future of their local Victorian and Edwardian buildings and landscapes.

It provides information to owners of Victorian and Edwardian houses about how they can better look after their precious buildings. It helps people understand, appreciate and enjoy the architectural heritage of the Victorian and Edwardian period through its publications and educational programmes.

The Victorian Society, 1 Priory Gardens, LONDON W4 1TT

Registered Charity No. 1081435

Tel. 020 8994 1019 www.victoriansociety.org.uk

Follow the Victorian Society on Twitter: @thevicsoc